

Sheet 1 of 1

Drawing Description:
 Dimensional Details Of Winkhaus'
 Standard STV Two Hook
 Residential Multi-point Door-lock
 System on a F16 rail.

Tech Spec Ref:
 STV-FG 1660 M2

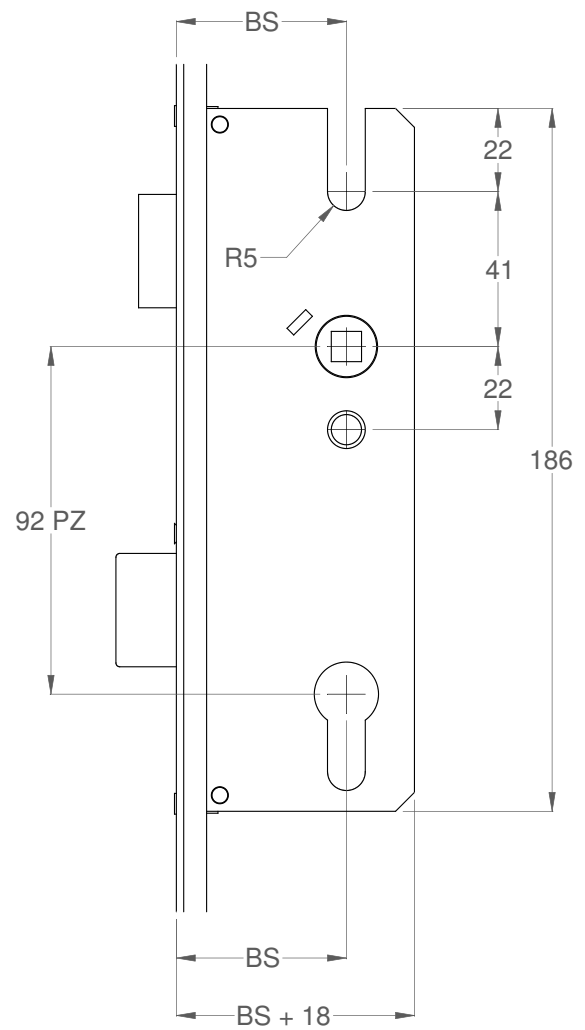
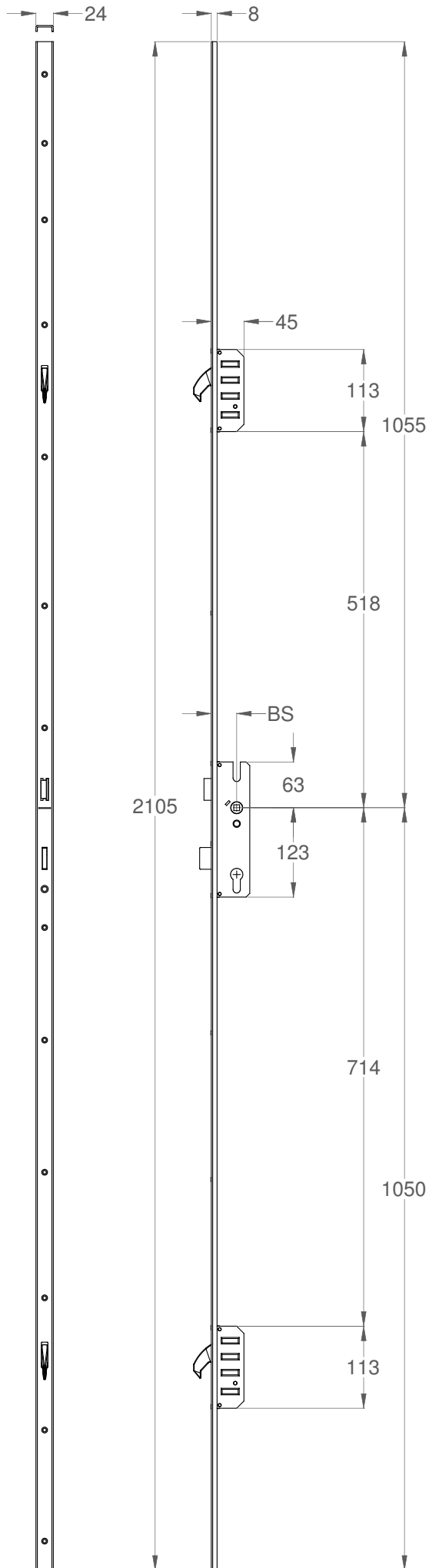

Sheet 1 of 1	Drawing Description: Dimensional Details Of Winkhaus' Short STV Two Hook Residential Multi-point Door-lock System on a U24-8mm rail.
	Tech Spec Ref: STV-UG 2488 M2

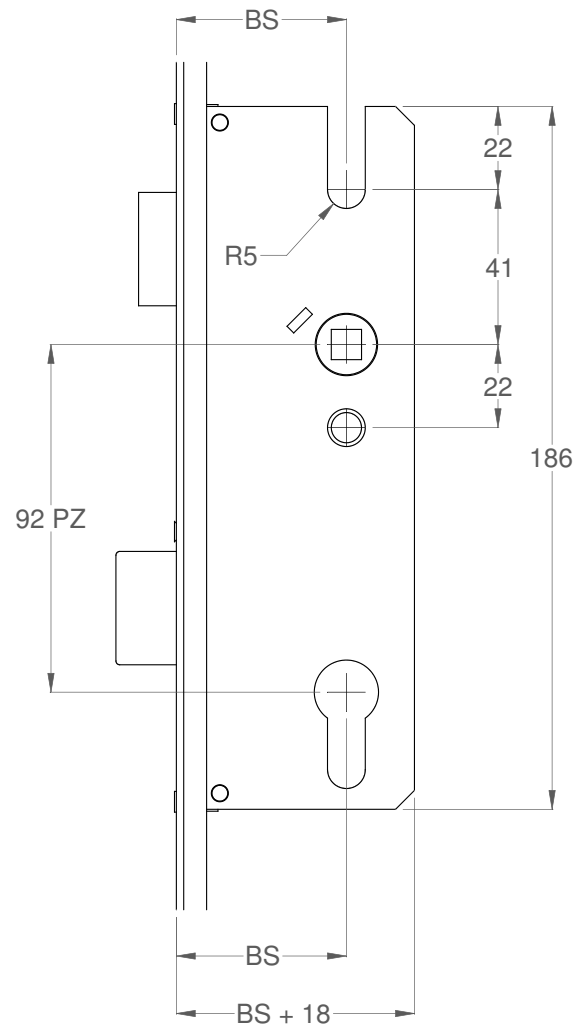
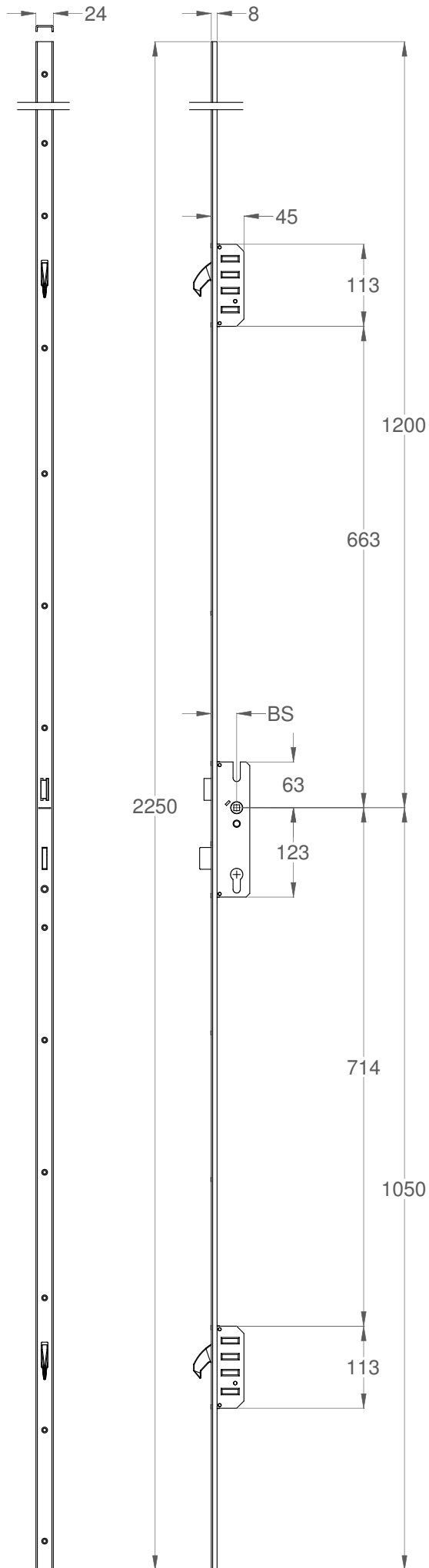

Sheet 1 of 1	<p>Drawing Description: Dimensional Details Of Winkhaus' Standard STV Two Hook Residential Multi-point Door-lock System on a U24-8mm rail.</p>
	<p>Tech Spec Ref: STV-UG 2471 M2</p>

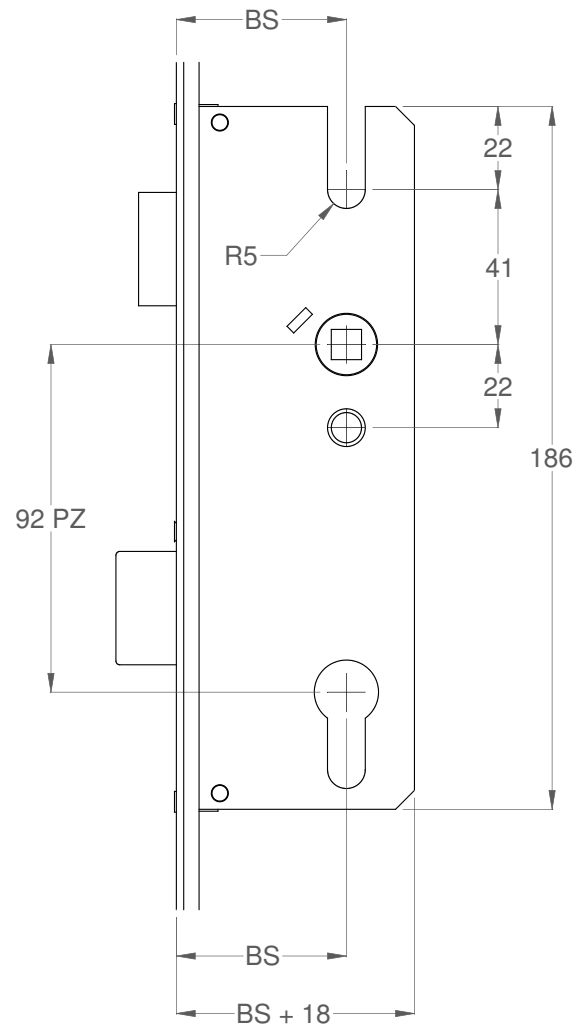
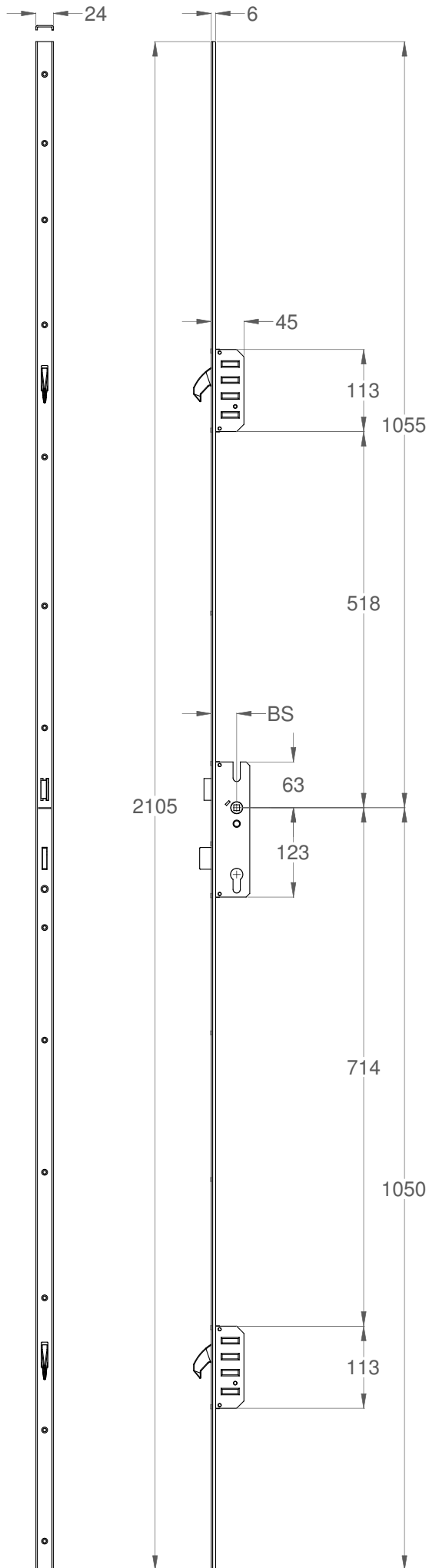

Sheet 1 of 1	<p>Drawing Description: Dimensional Details Of Winkhaus' Short STV Two Hook Residential Multi-point Door-lock System on a U24-6mm rail.</p>
	<p>Tech Spec Ref: STV-UG 2462 M2</p>

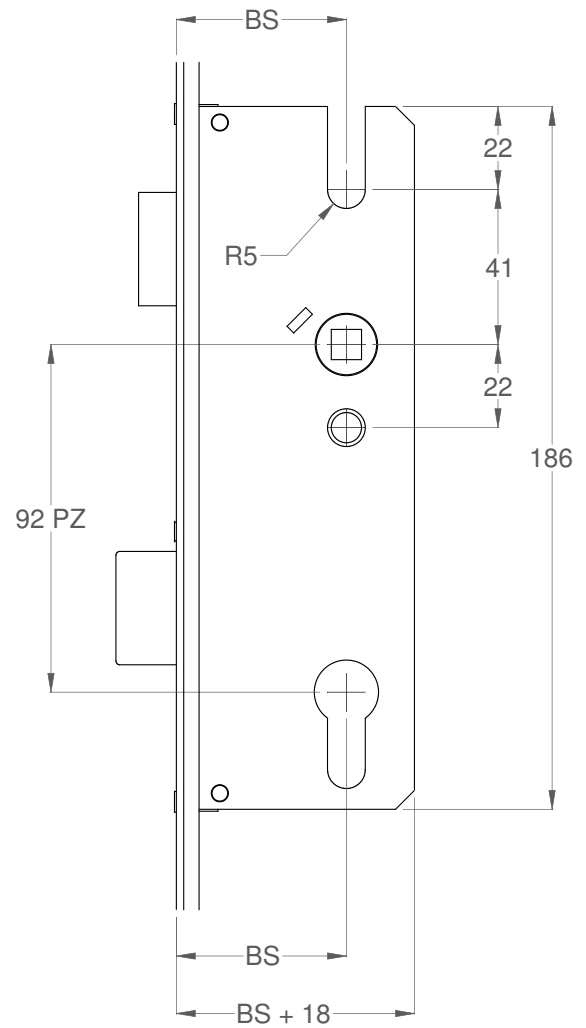
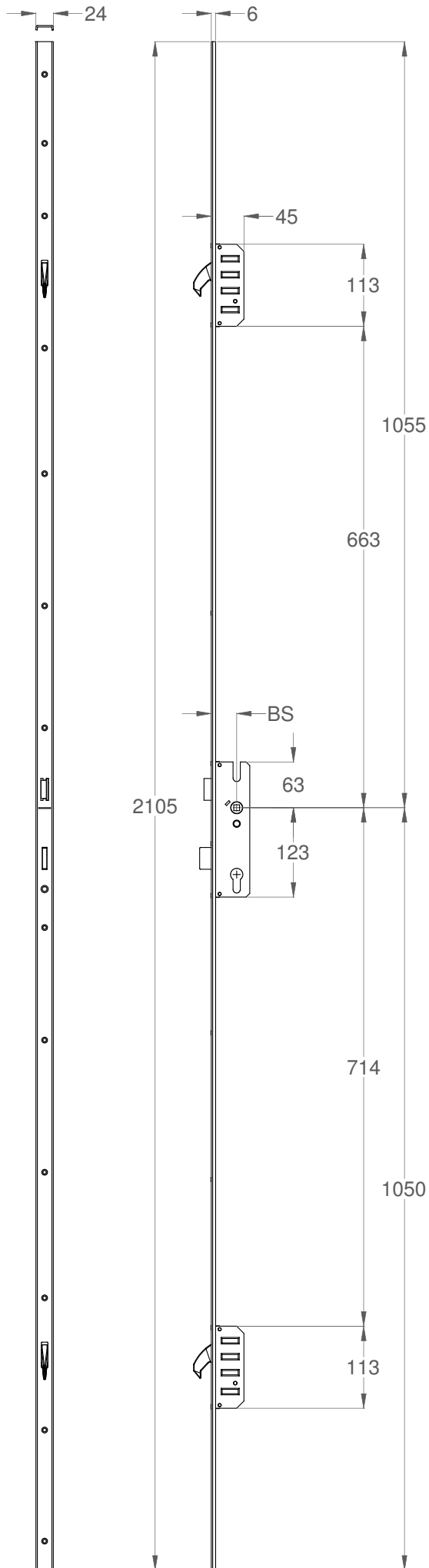

Sheet 1 of 1	<p>Drawing Description: Dimensional Details Of Winkhaus' Standard STV Two Hook Residential Multi-point Door-lock System on a U24-6mm rail.</p>
	<p>Tech Spec Ref: STV-UG 2460 M2</p>

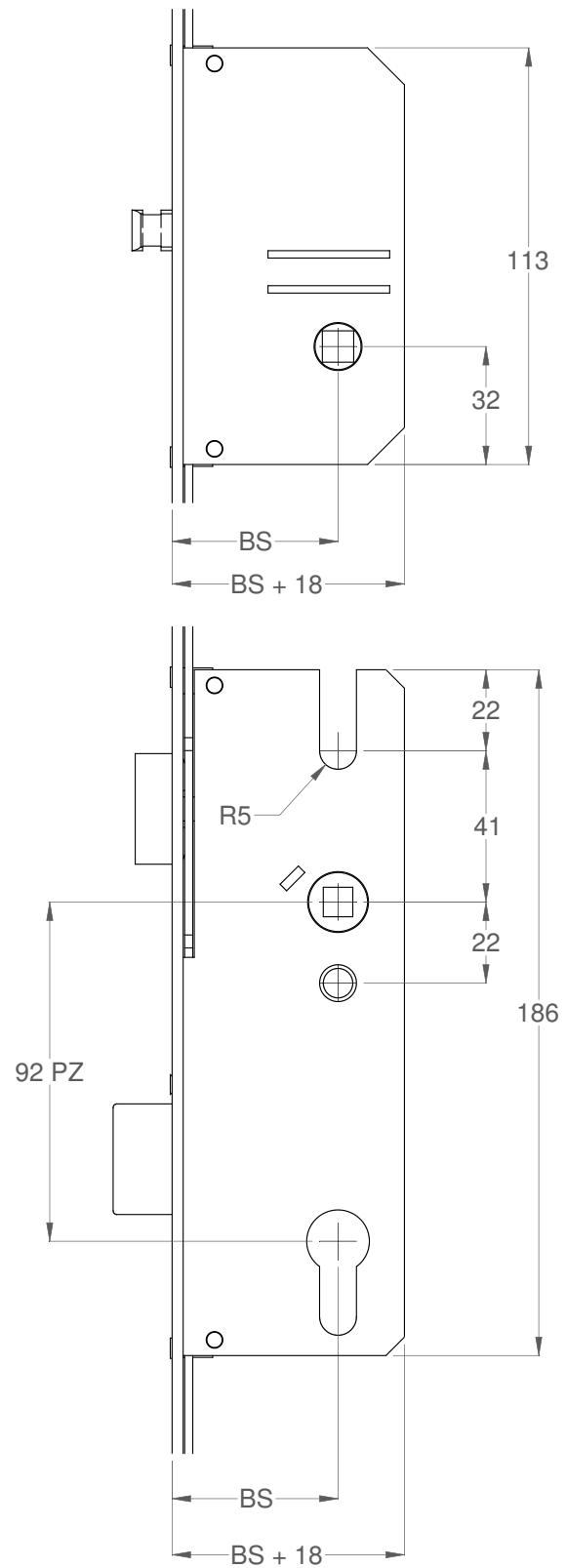
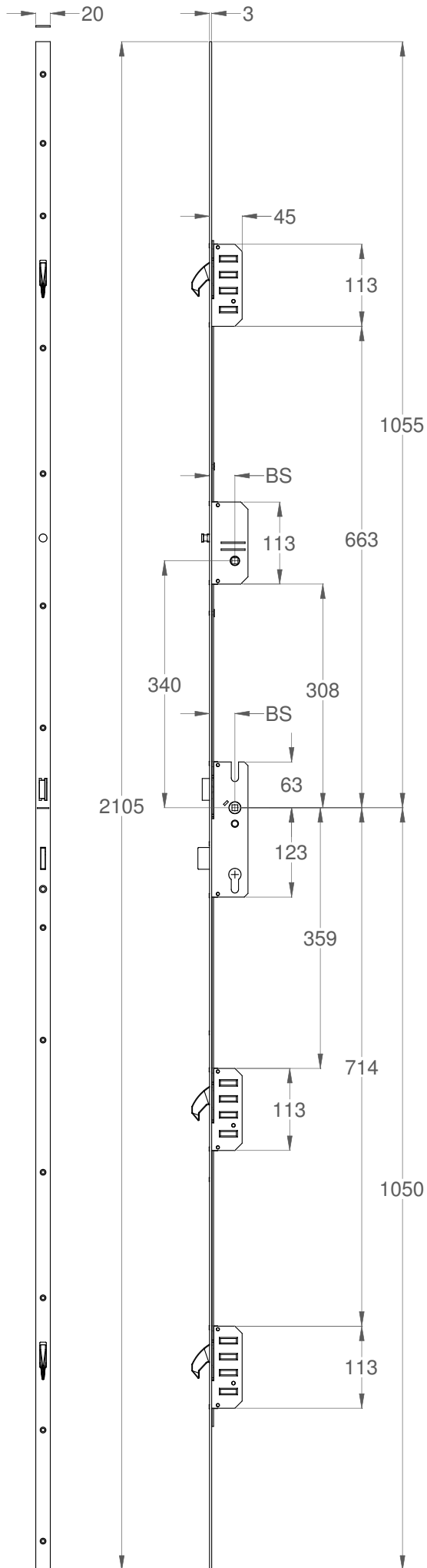

Sheet 1 of 1	<p>Drawing Description: Dimensional Details Of Winkhaus' Entryguard STV Three Hook Residential Multi-point Door-lock System on a F20 rail.</p>
	<p>Tech Spec Ref: STV-FGPW 2060 M3</p>

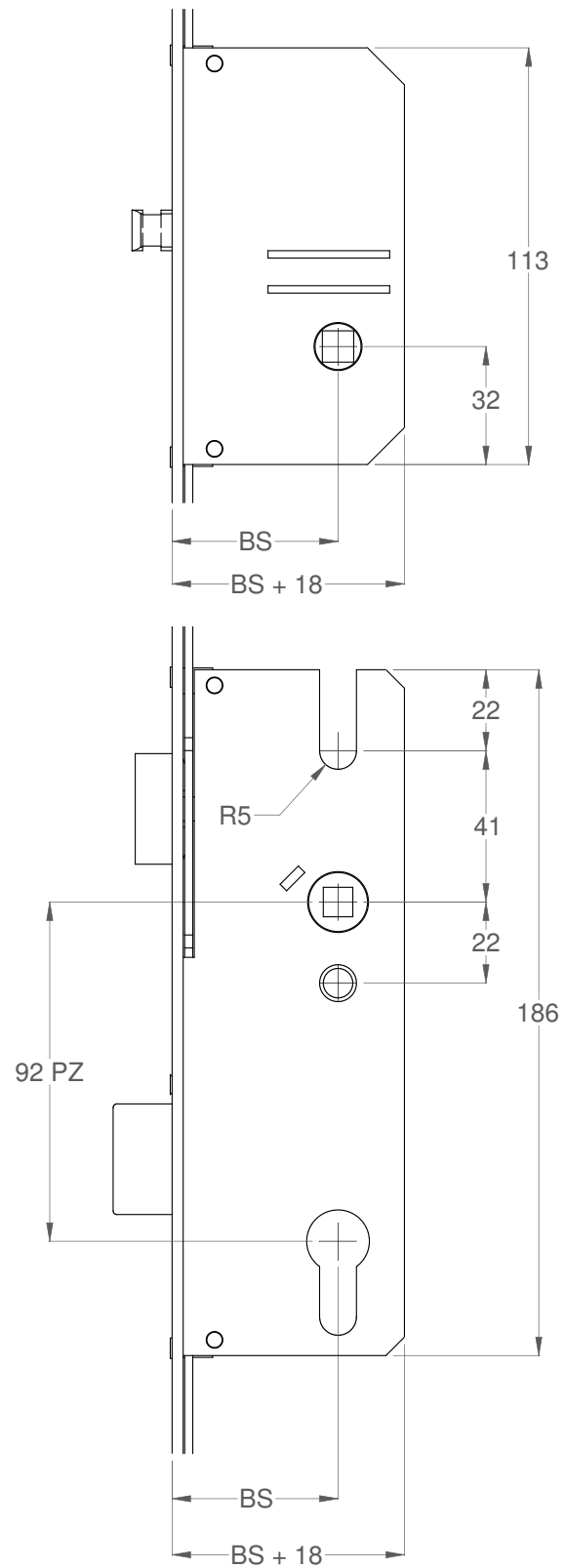
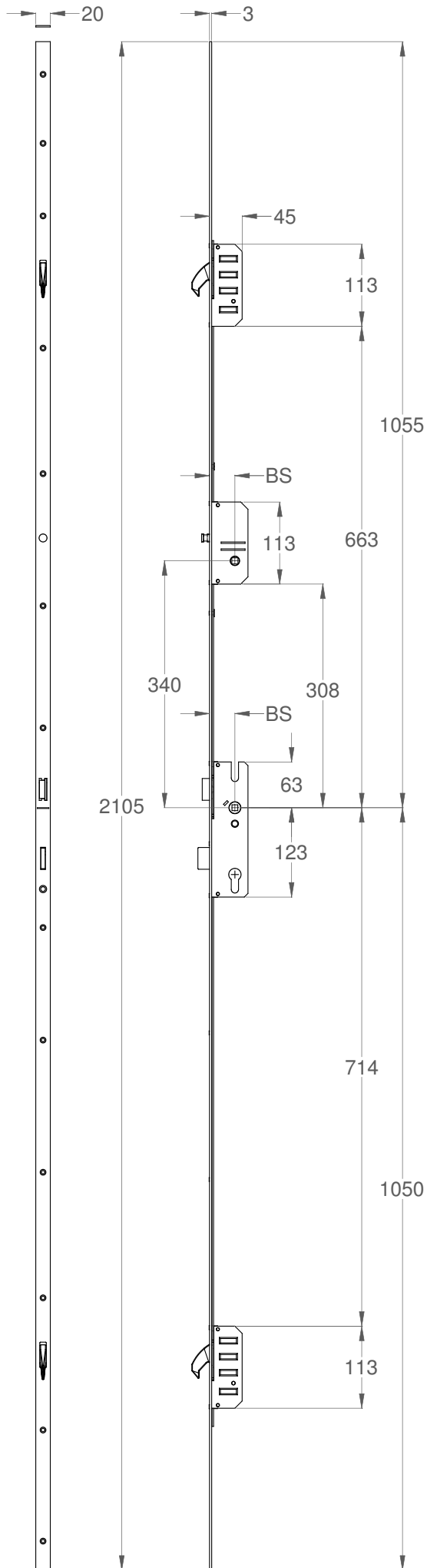

Sheet 1 of 1

Drawing Description:
 Dimensional Details Of Winkhaus' Entryguard STV Two Hook Residential Multi-point Door-lock System on a F20 rail.

Tech Spec Ref:
 STV-FGPW 2060 M2

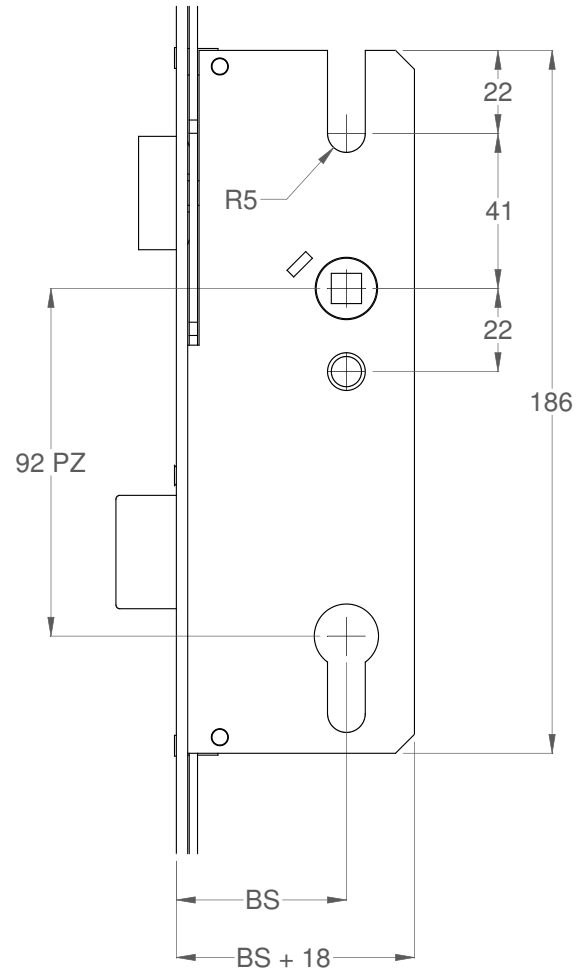
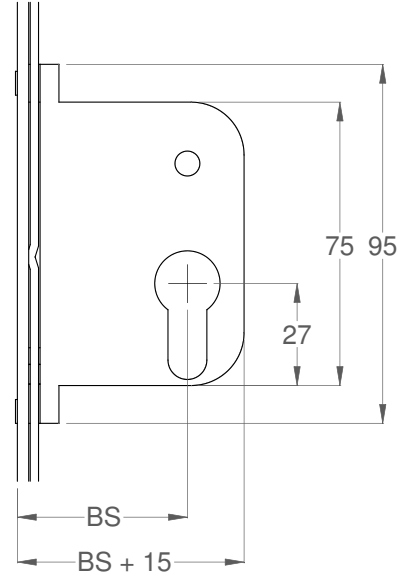
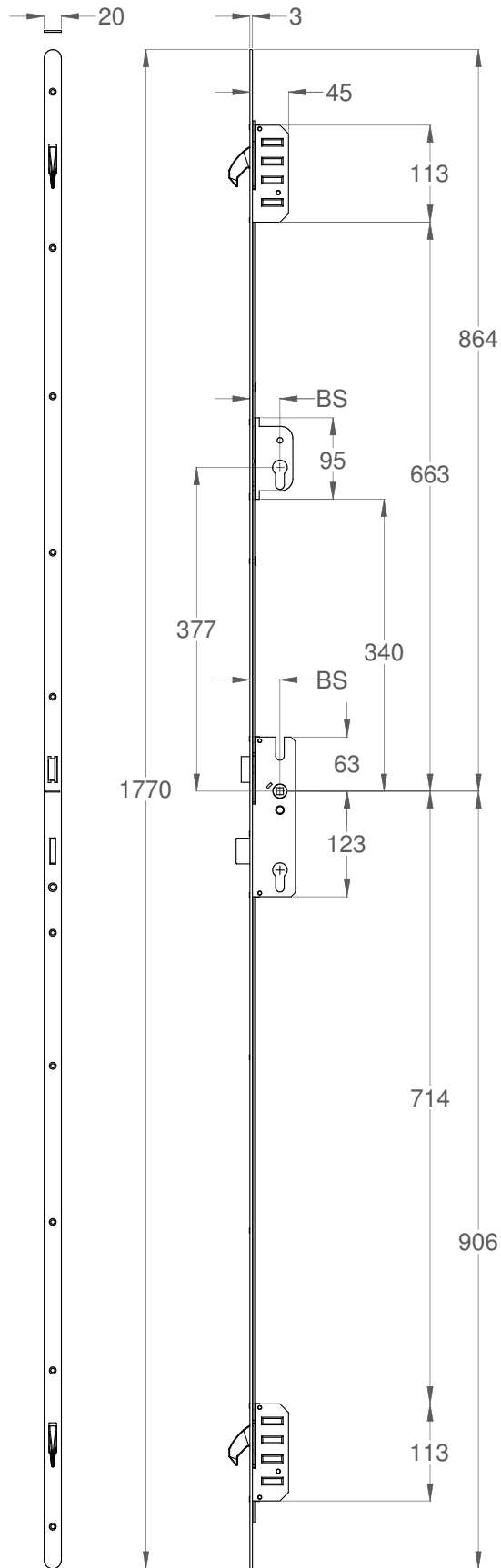

Sheet 1 of 1	Drawing Description: Dimensional Details Of Winkhaus' FA STV Two Hook Residential Multi-point Door-lock System on a F20 rail.
	Tech Spec Ref: STV-FGPA 2070 M2

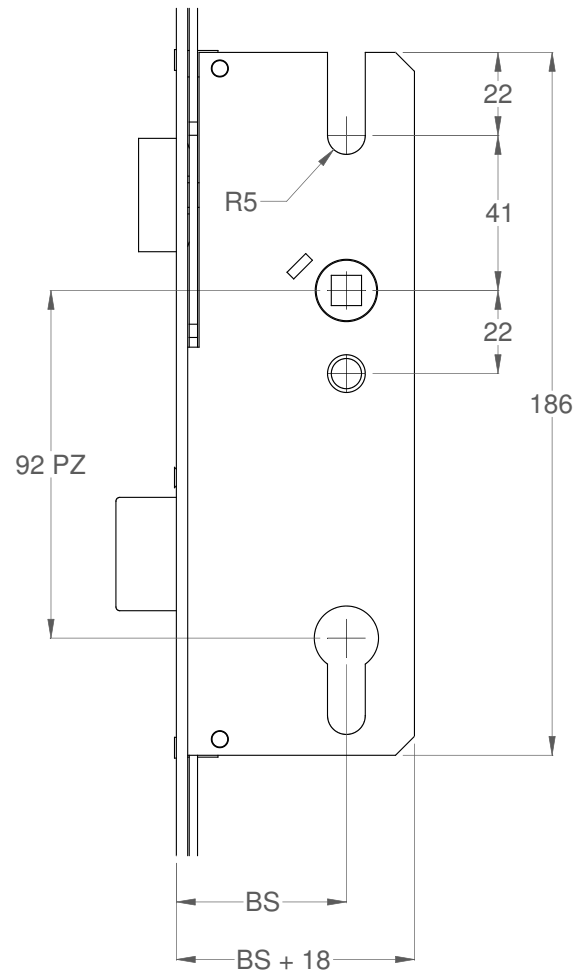
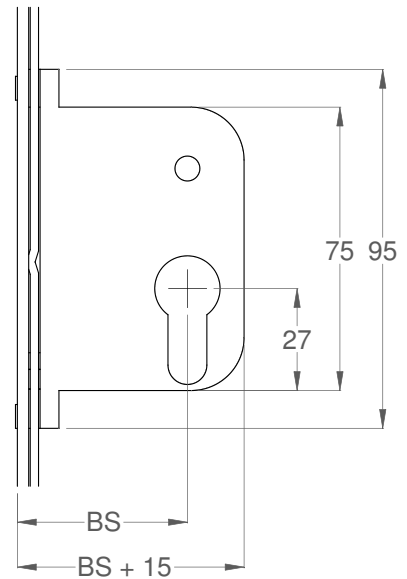
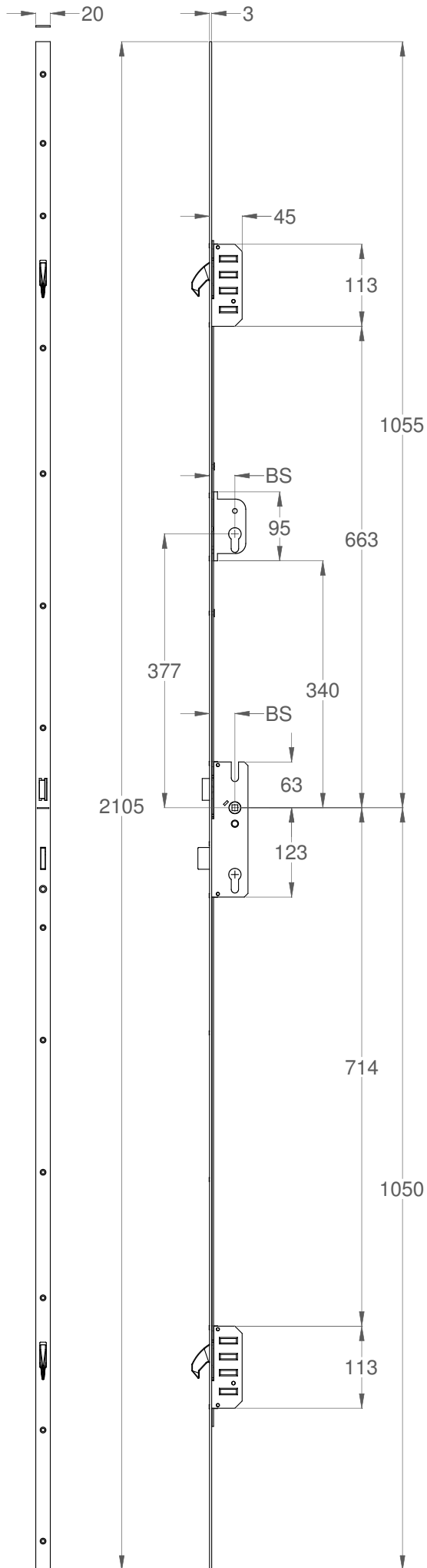

Sheet 1 of 1	Drawing Description: Dimensional Details Of Winkhaus' FA STV Two Hook Residential Multi-point Door-lock System on a F20 rail.
	Tech Spec Ref: STV-FGPA 2060 M2

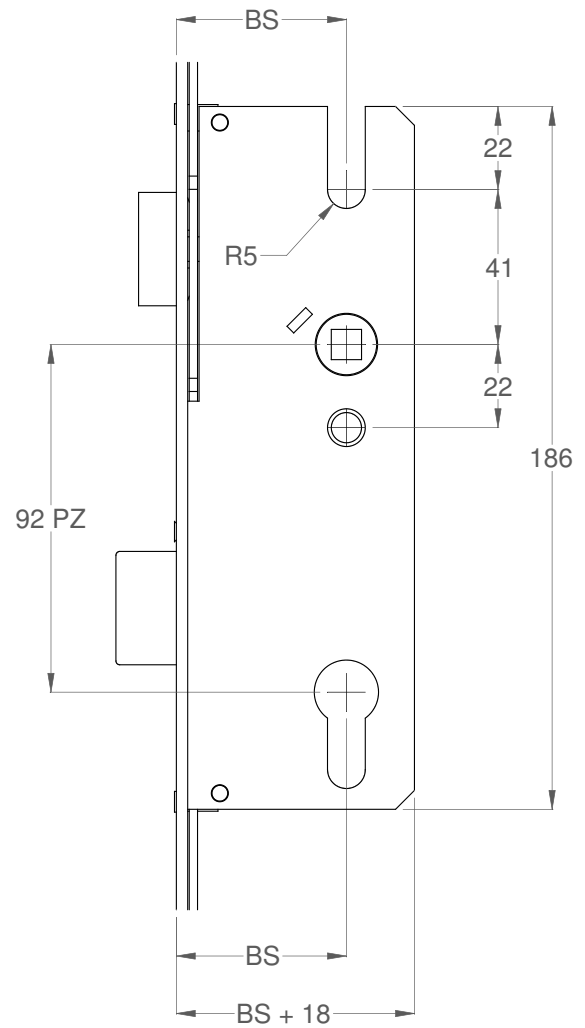
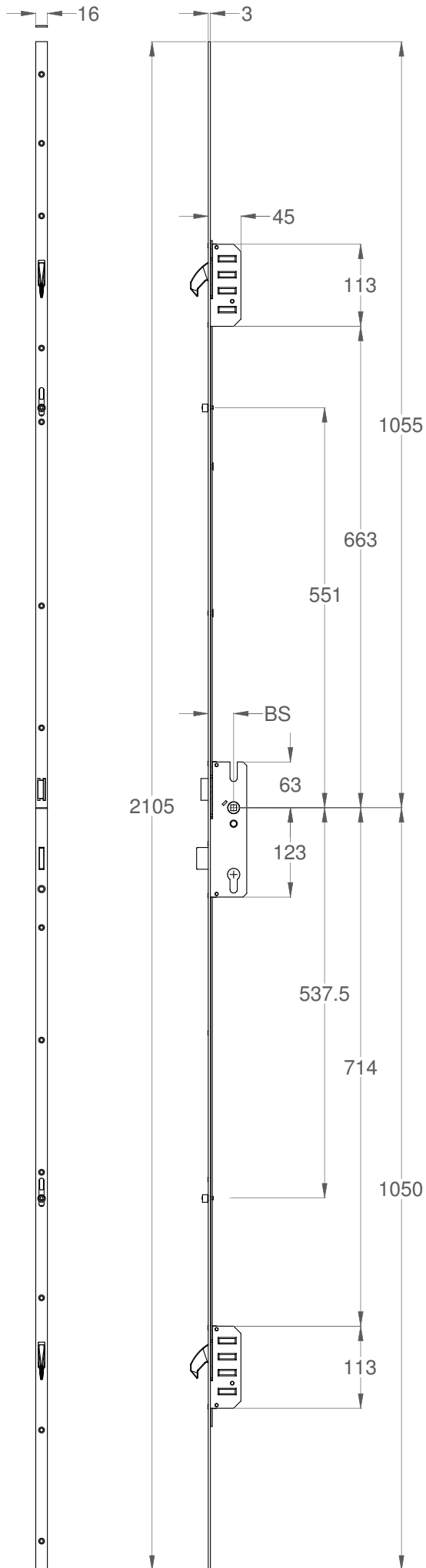

Sheet 1 of 1	<p>Drawing Description: Dimensional Details Of Winkhaus' STV Two Hook Two Roller Residential Multi-point Door-lock System on a F16 rail.</p>
	<p>Tech Spec Ref: STV-FGP 1660 R2/M2</p>

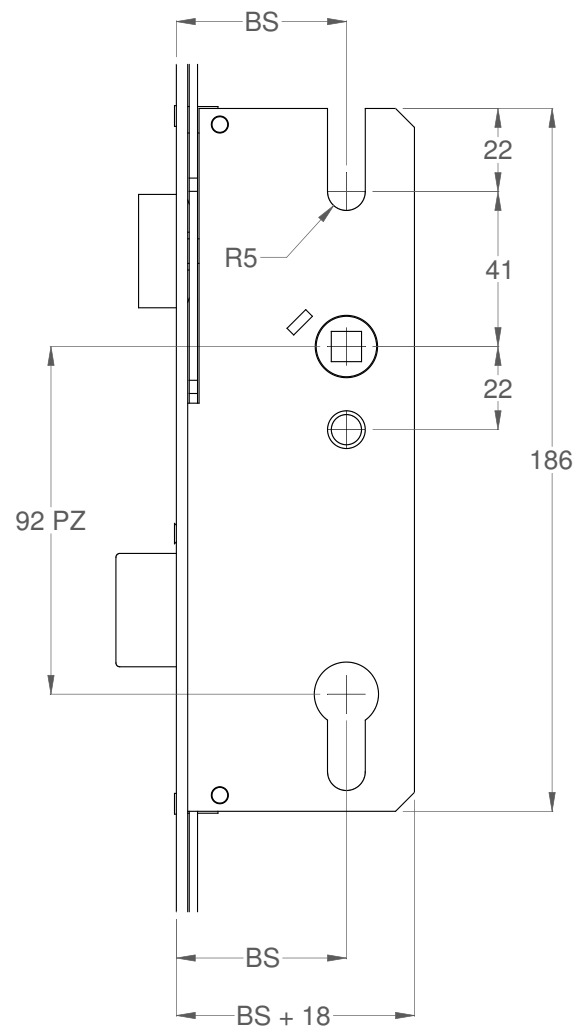
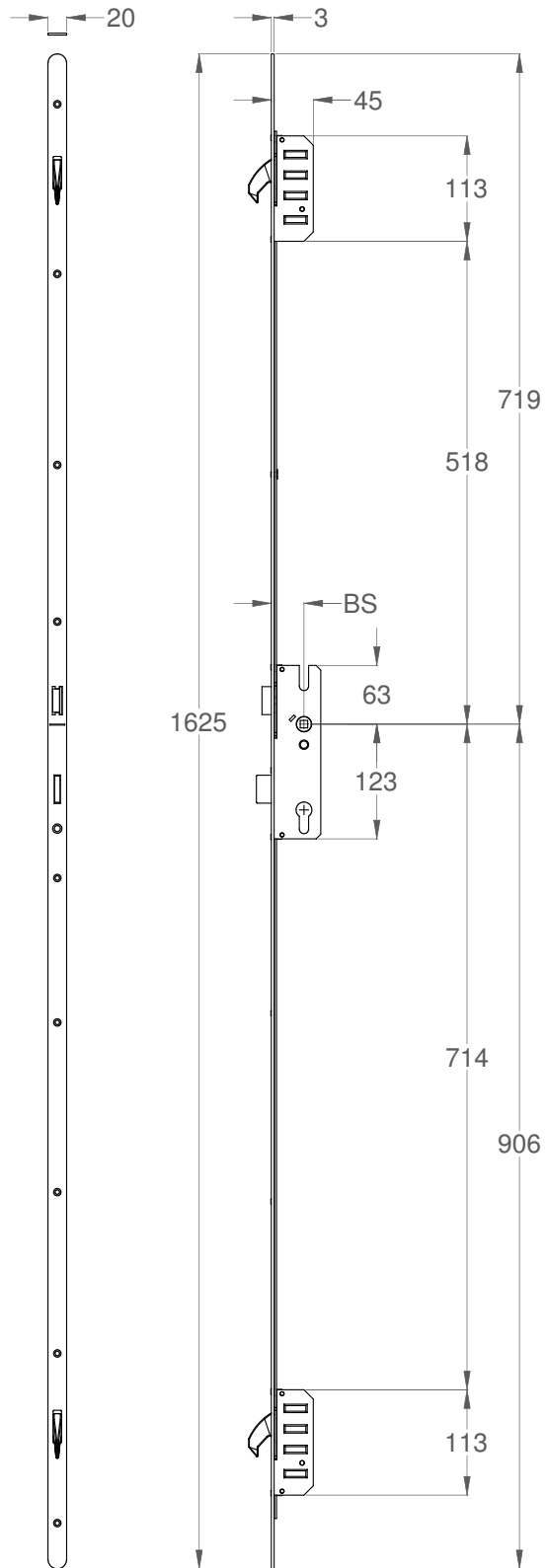

Sheet 1 of 1	<p>Drawing Description: Dimensional Details Of Winkhaus' Short STV Two Hook Residential Multi-point Door-lock System on a F20 rail.</p>
	<p>Tech Spec Ref: STV-FG 2070-62 M2</p>

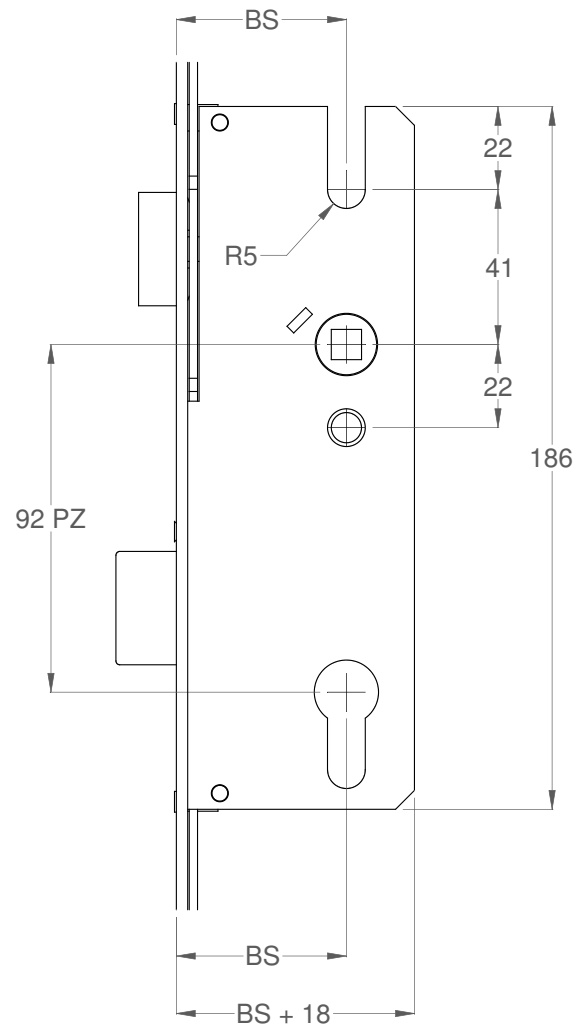
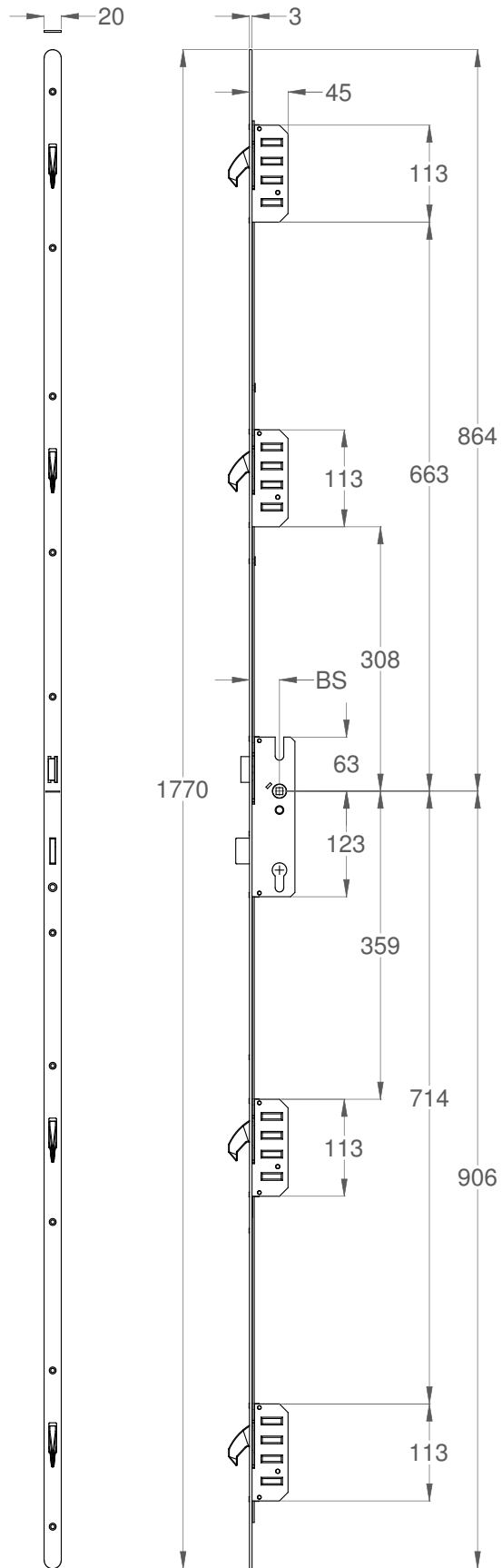

Sheet 1 of 1

Drawing Description:
 Dimensional Details Of Winkhaus'
 Standard STV Four Hook
 Residential Multi-point Door-lock
 System on a F20 rail.

Tech Spec Ref:
 STV-FG 2070 M4

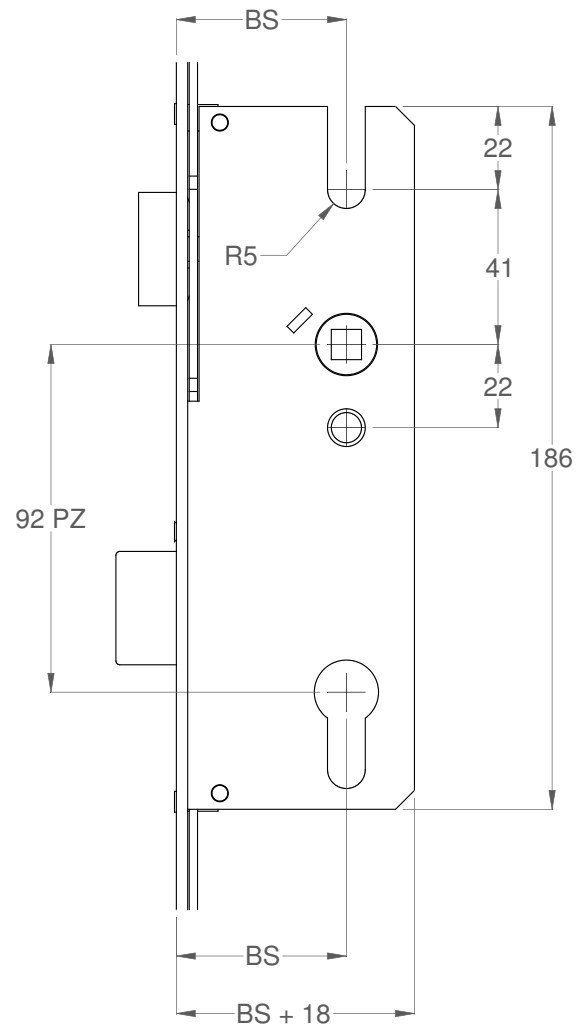
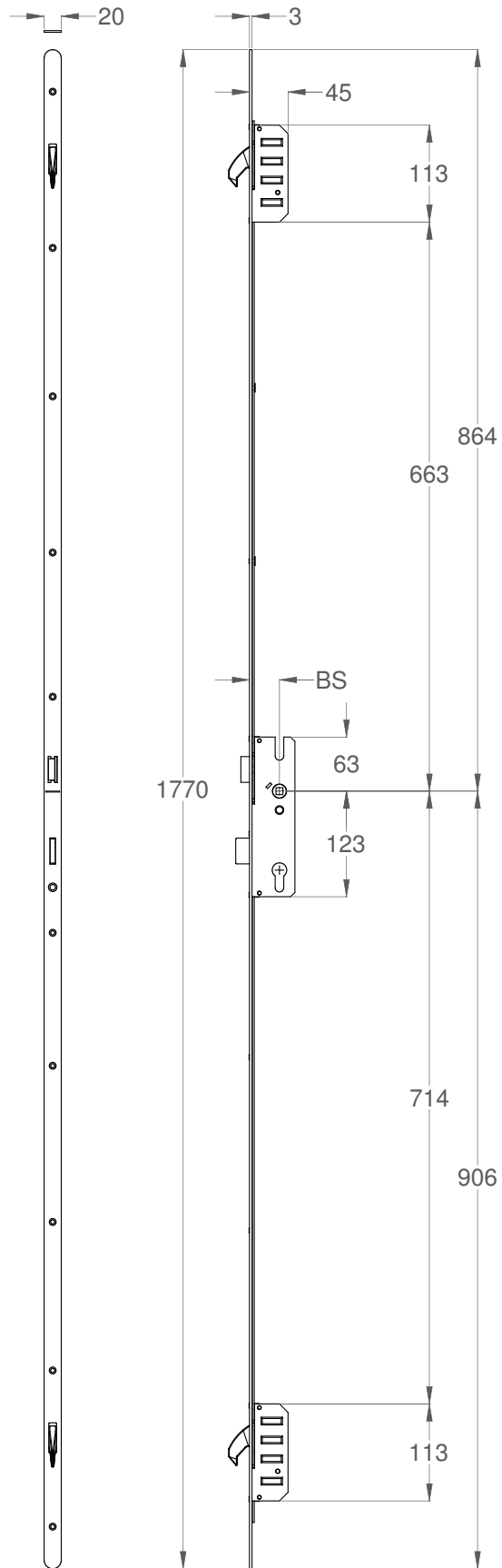

Sheet 1 of 1	<p>Drawing Description: Dimensional Details Of Winkhaus' Standard STV Two Hook Residential Multi-point Door-lock System on a F20 rail.</p>
	<p>Tech Spec Ref: STV-FG 2070 M2</p>

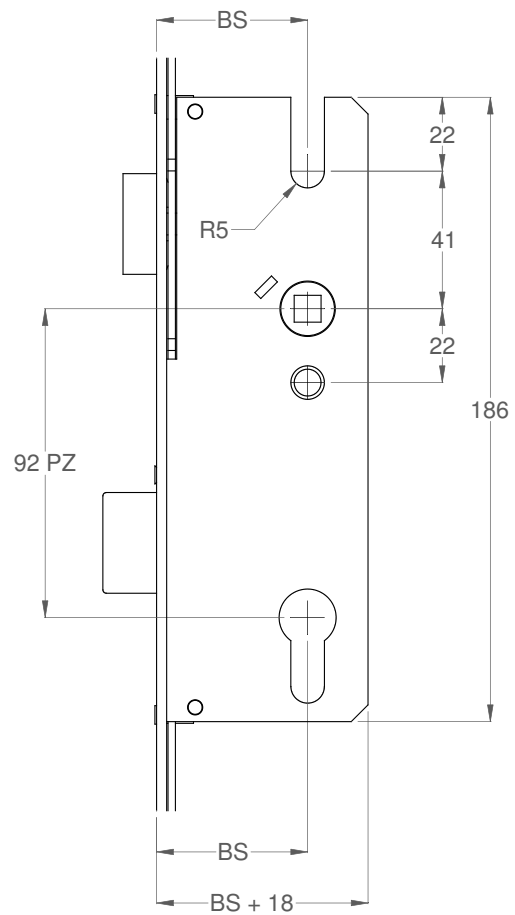
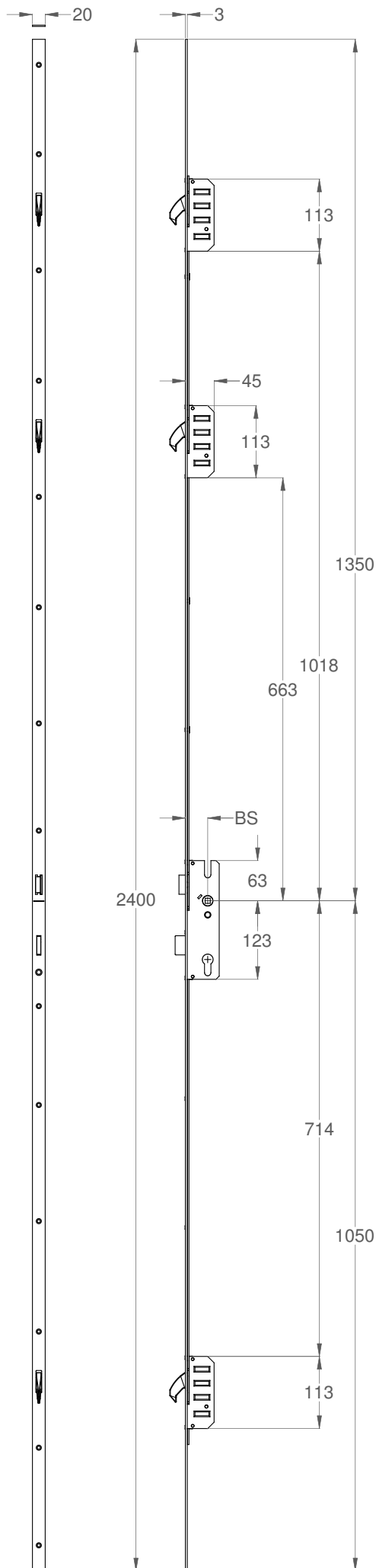

Sheet 1 of 1	Drawing Description: Dimensional Details Of Winkhaus' Tall STV Three Hook Residential Multi-point Door-lock System on a F20 rail.
	Tech Spec Ref: STV-FG 2069 M3

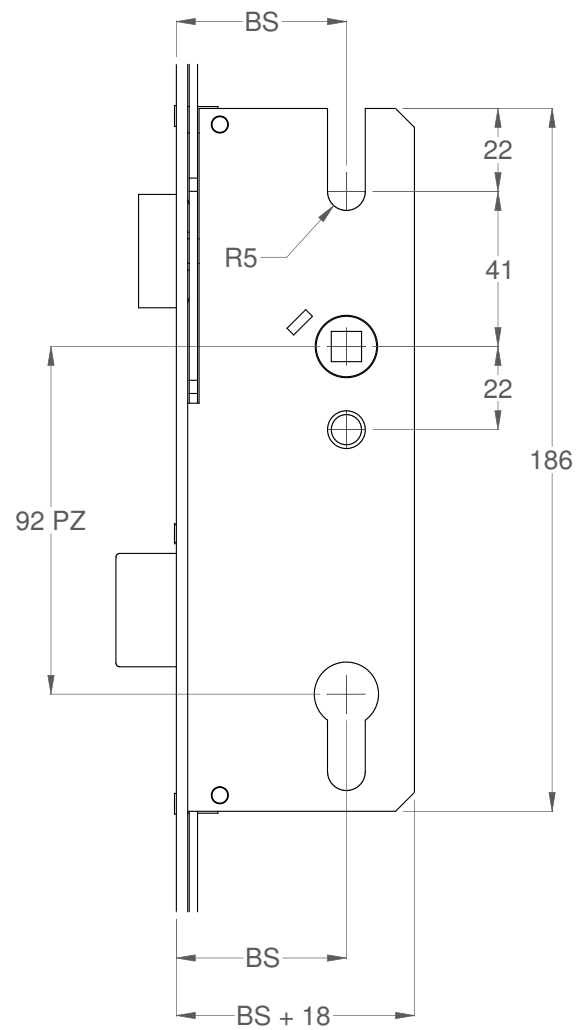
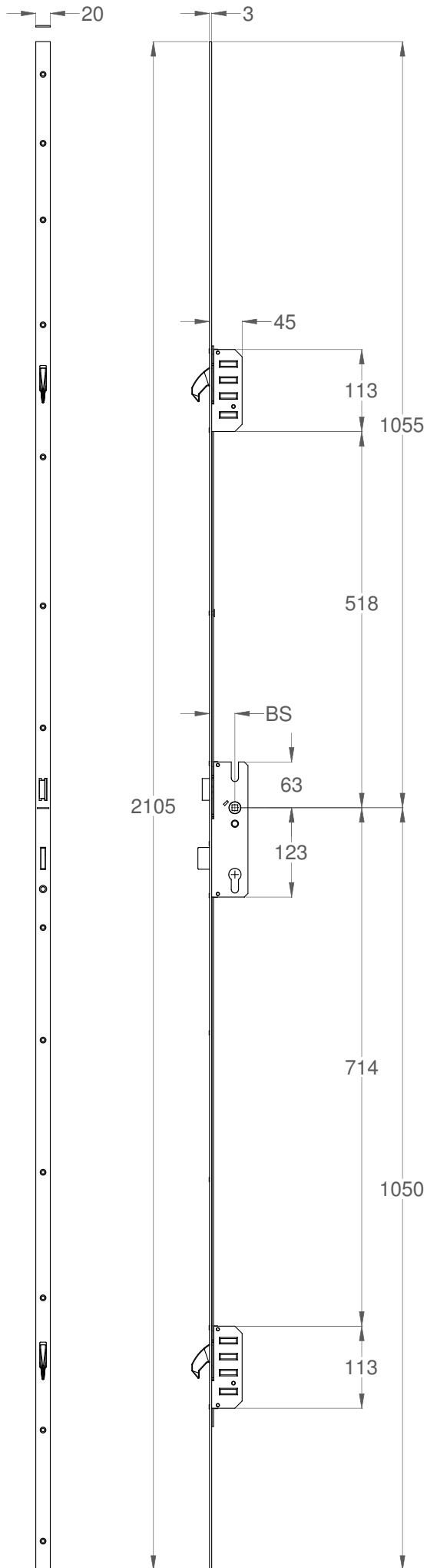

Sheet 1 of 1

Drawing Description:
 Dimensional Details Of Winkhaus' Short STV Two Hook Residential Multi-point Door-lock System on a F20 rail.

Tech Spec Ref:
 STV-FG 2062 M2

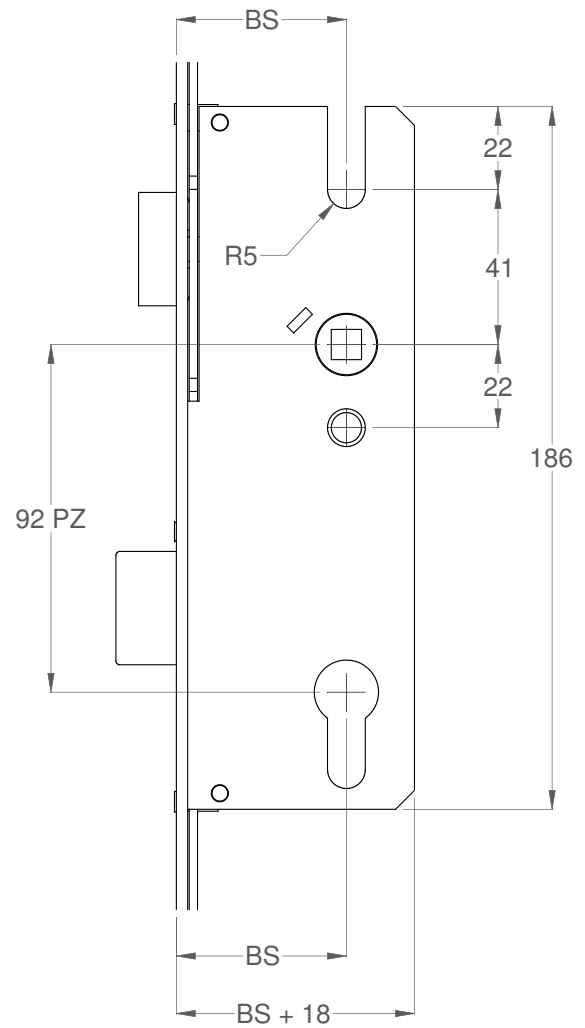
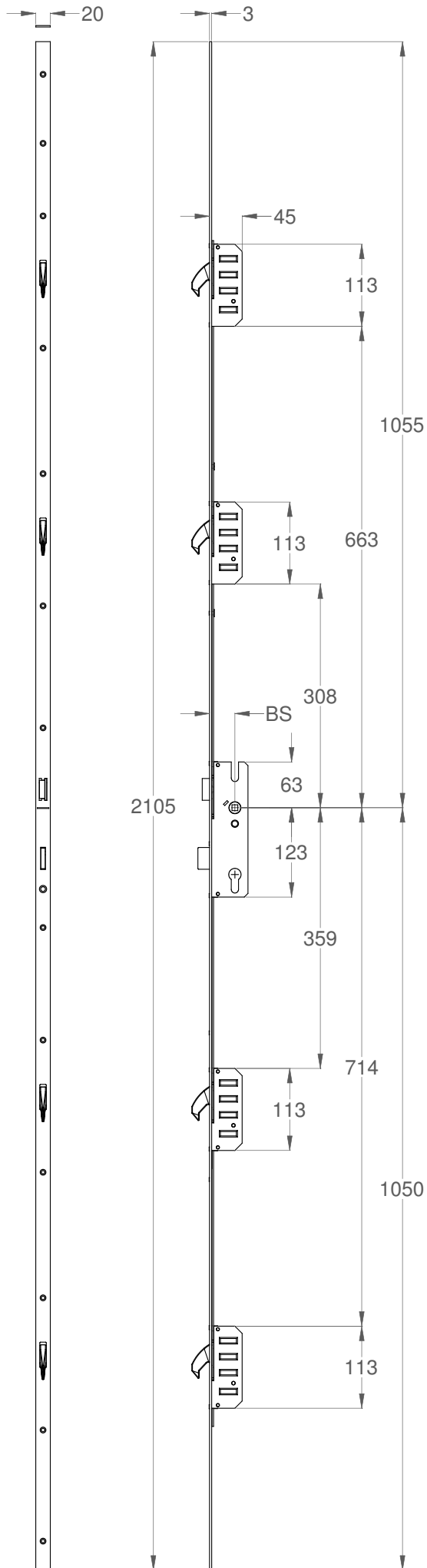

Sheet 1 of 1	<p>Drawing Description: Dimensional Details Of Winkhaus' Standard STV Four Hook Residential Multi-point Door-lock System on a F20 rail.</p>
	<p>Tech Spec Ref: STV-FG 2060 M4</p>

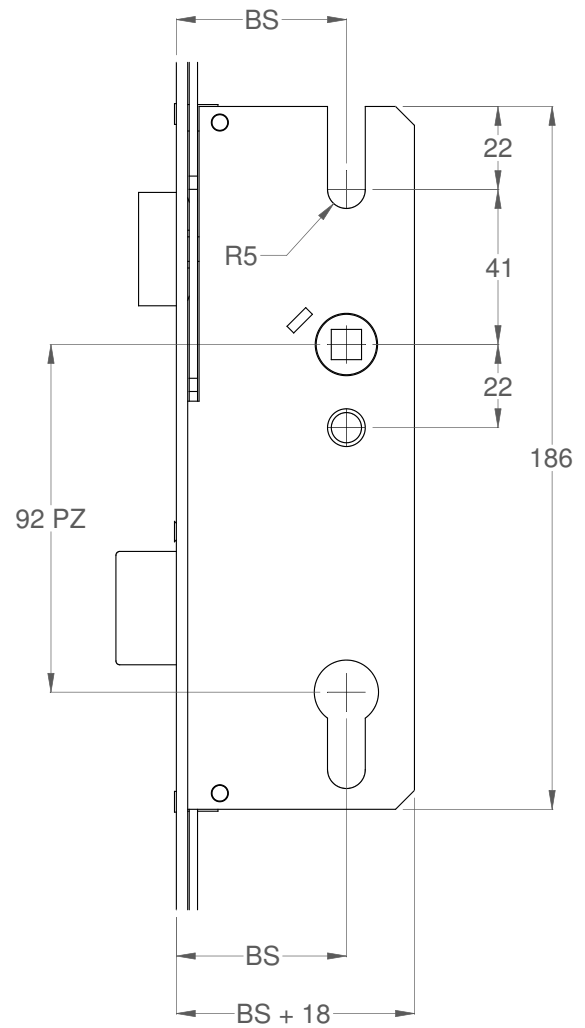
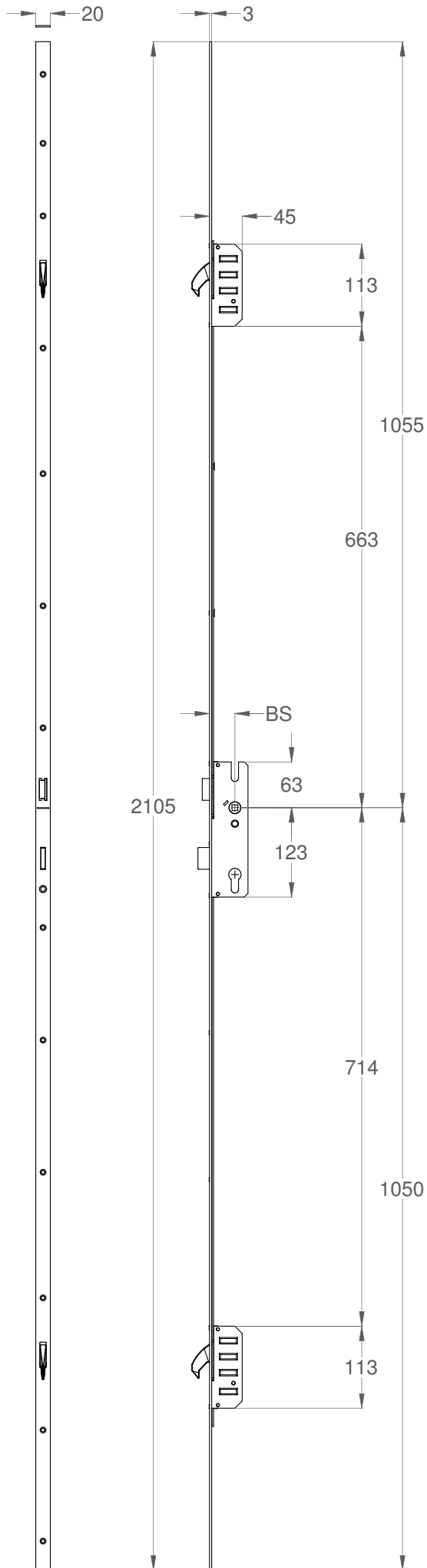

Sheet 1 of 1	<p>Drawing Description: Dimensional Details Of Winkhaus' Standard STV Two Hook Residential Multi-point Door-lock System on a F20 rail.</p>
	<p>Tech Spec Ref: STV-FG 2060 M2</p>

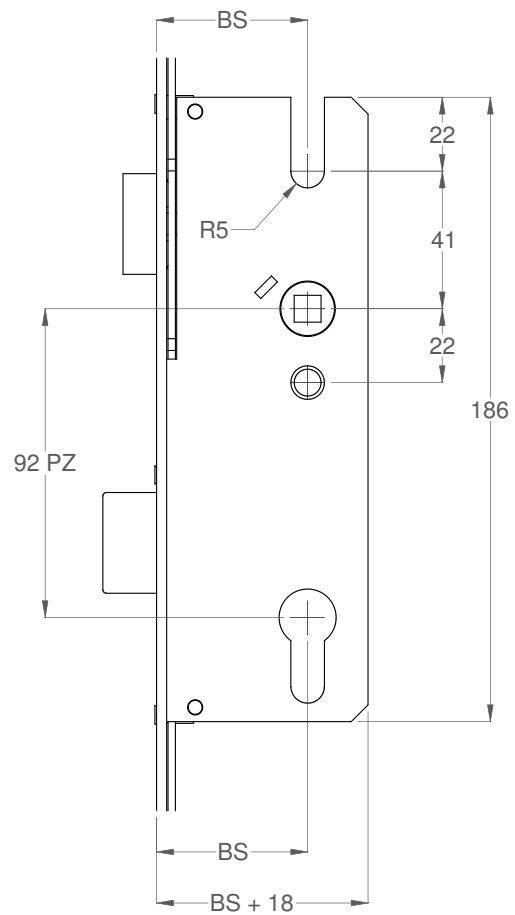
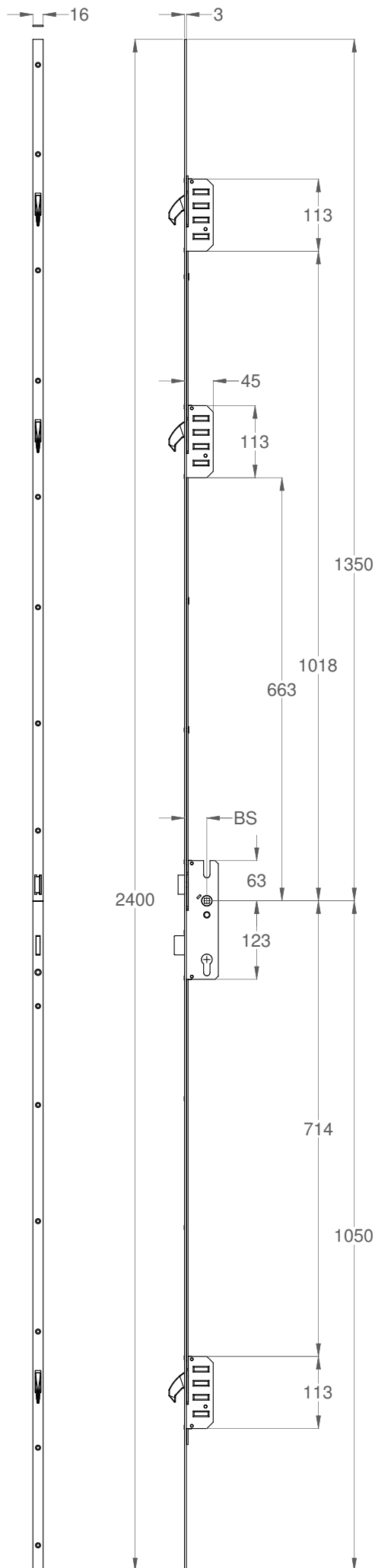

Sheet 1 of 1	Drawing Description: Dimensional Details Of Winkhaus' Tall STV Three Hook Residential Multi-point Door-lock System on a F16 rail.
	Tech Spec Ref: STV-FG 1669 M3

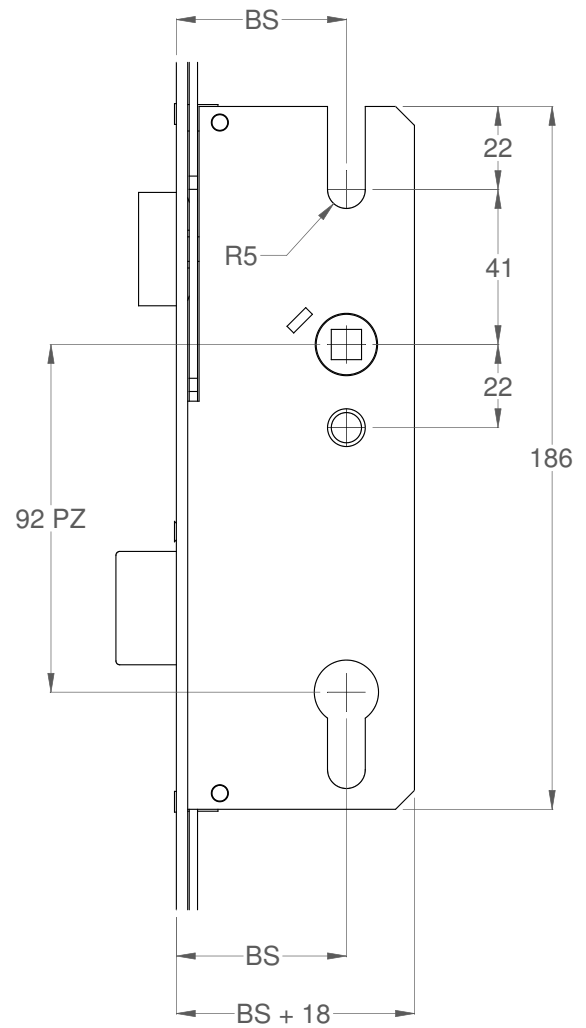
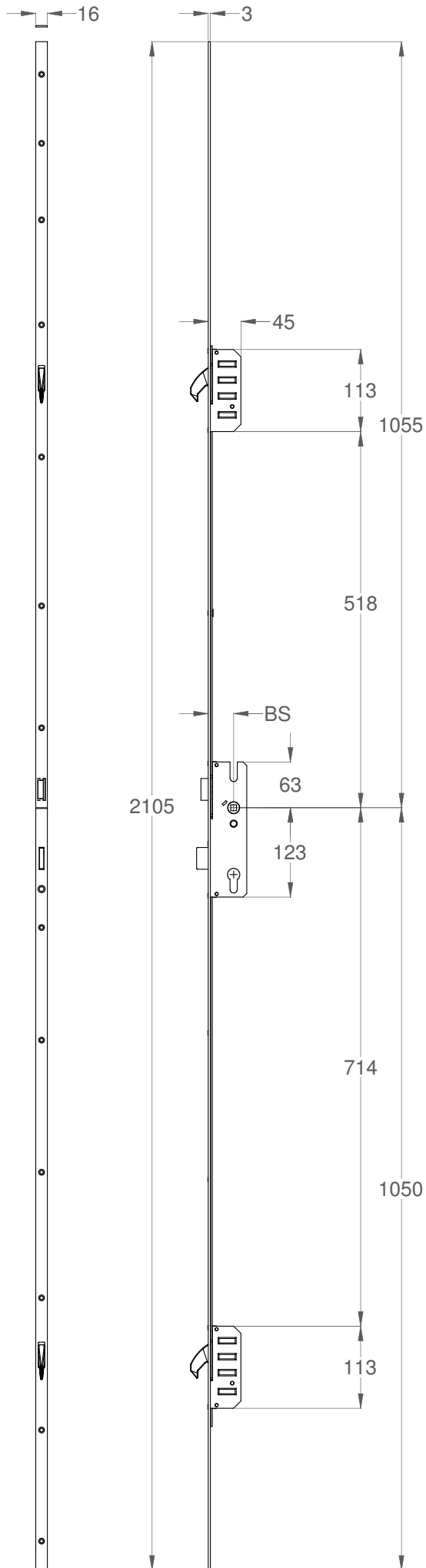

Sheet 1 of 1	<p>Drawing Description: Dimensional Details Of Winkhaus' Short STV Two Hook Residential Multi-point Door-lock System on a F16 rail.</p>
	<p>Tech Spec Ref: STV-FG 1662 M2</p>

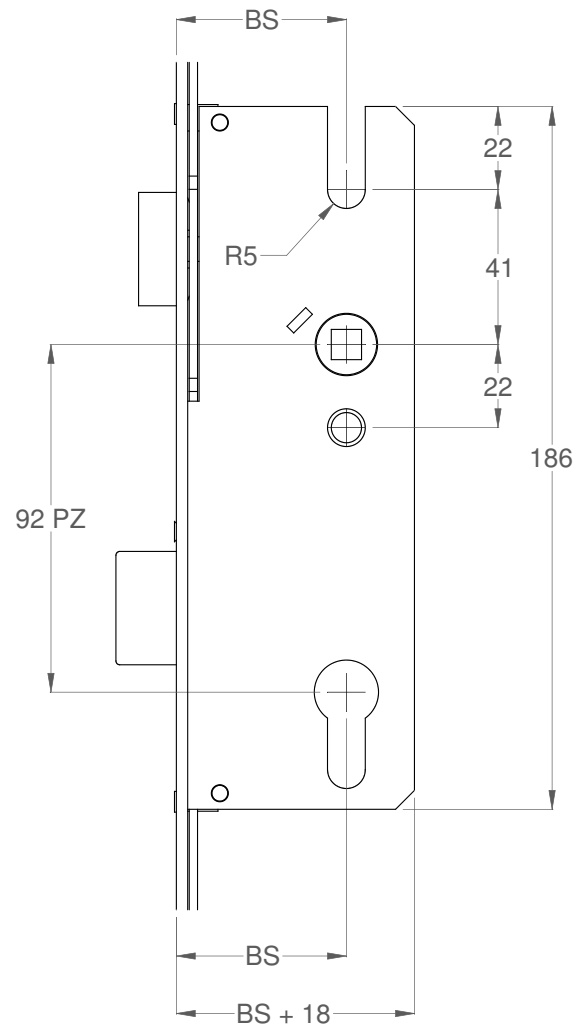
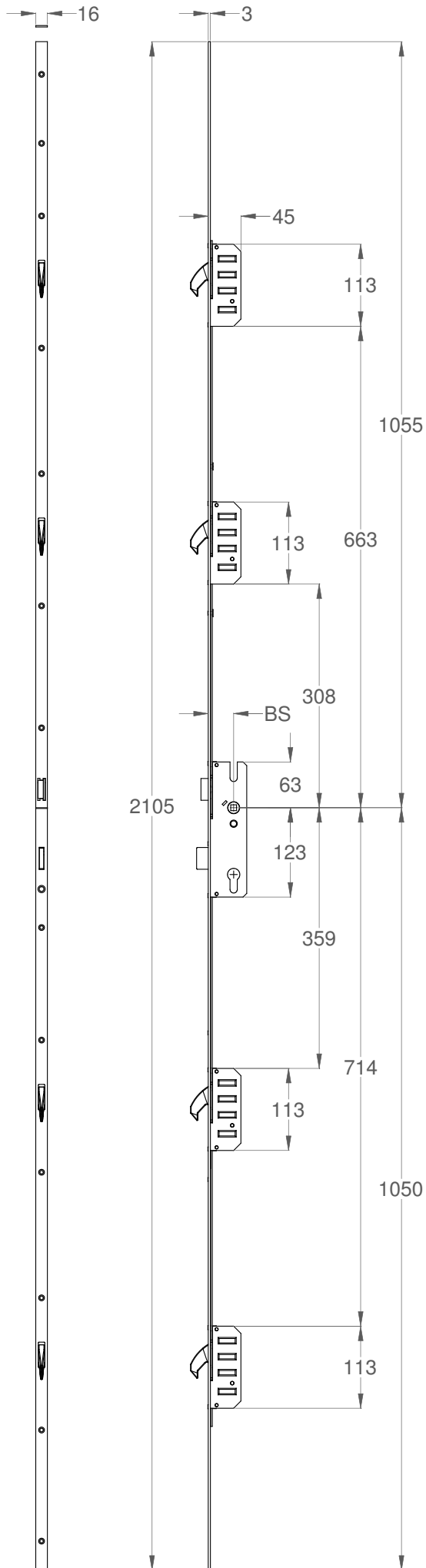

Sheet 1 of 1	<p>Drawing Description: Dimensional Details Of Winkhaus' Standard STV Four Hook Residential Multi-point Door-lock System on a F16 rail.</p>
	<p>Tech Spec Ref: STV-FG 1660 M4</p>